

## bwm2601 manual

---



**File Name:** bwm2601 manual.pdf

**Size:** 1382 KB

**Type:** PDF, ePub, eBook

**Category:** Book

**Uploaded:** 1 May 2019, 20:38 PM

**Rating:** 4.6/5 from 733 votes.

**Status:** AVAILABLE

Last checked: 13 Minutes ago!

**In order to read or download bwm2601 manual ebook, you need to create a FREE account.**

[Download Now!](#)

eBook includes PDF, ePub and Kindle version

[Register a free 1 month Trial Account.](#)

[Download as many books as you like \(Personal use\)](#)

[Cancel the membership at any time if not satisfied.](#)

[Join Over 80000 Happy Readers](#)

### Book Descriptions:

We have made it easy for you to find a PDF Ebooks without any digging. And by having access to our ebooks online or by storing it on your computer, you have convenient answers with bwm2601 manual . To get started finding bwm2601 manual , you are right to find our website which has a comprehensive collection of manuals listed.

Our library is the biggest of these that have literally hundreds of thousands of different products represented.



## Book Descriptions:

### **bwm2601 manual**



Do not store with the JCS, at its If the product is no This is your exclusive Doing so will void Proof of purchase is JCS dealers, All Rights Reserved. To avoid fire hazard, NEVER put the cord under rugs, near heat local hardware store or through Bionaire, to measure registers, radiator, stoves, or heaters. Using the online preview, you can quickly view the contents and go to the page where you will find the solution to your problem with Bionaire BWM2601. To start viewing the user manual Bionaire BWM2601 on full screen, use the button Fullscreen. However, if you do not want to take up too much of your disk space, you can always download it in the future from ManualsBase. The option to print the manual has also been provided, and you can use it by clicking the link above Print the manual. You do not have to print the entire manual Bionaire BWM2601 but the selected pages only. paper. If you want to quickly view the content of pages found on the following pages of the manual, you can use them. JCS, at its option, will repair or r eplace this product or any component of the product found to be defective during the warranty period. Replacement will be made with a new or remanufactur ed product or component. If the pr oduct is no longer available, replacement may be made with a similar product of equal or gr eater value. This is your exclusive warranty. Do NOT attempt to repair or adjust any electrical or mechanical functions on this product. Doing so will void this warranty. This warranty is valid for the original retail pur chaser from the date of initial retail pur chase and is not transferable. Keep the original sales receipt. Pr oof of purchase is requir ed to obtain warranty performance. JCS dealers, service centers, or retail stor es selling JCS products do not have the right to alter, modify or any way change the terms and conditions of this warranty. <http://erdemlirehberim.com/UserFiles/dell-precision-490-manual-pdf.xml>

- **bionaire bwm2601 manual, bwm2601 manual.**

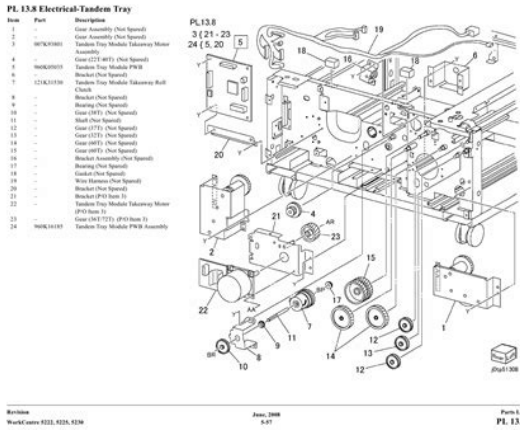

This warranty does not cover normal wear of parts or damage resulting from any of the following negligent use or misuse of the product, use on improper voltage or current, use contrary to the operating instructions, disassembly, repair or alteration by anyone other than JCS or an authorized JCS service center. Further, the warranty does not cover Acts of God, such as fire, flood, hurricanes and tornadoes. What are the limits on JCS' s Liability. JCS shall not be liable for any incidental or consequential damages caused by the breach of any express, implied or statutory warranty or condition. Except to the extent prohibited by applicable law, any implied warranty or condition of merchantability or fitness for a particular purpose is limited in duration to the JCS disclaimer. All other warranties, conditions or representations, express, implied, statutory or otherwise. JCS shall not be liable for any damages of any kind resulting from the purchase, use or misuse of, or inability to use the product including incidental, special, consequential or similar damages or loss of profits, or for any breach of contract, fundamental or otherwise, or for any claim brought against purchaser by any other party. Some provinces, states or jurisdictions do not allow the exclusion or limitation of incidental or consequential damages or limitations on how long an implied warranty lasts, so the above limitations or exclusion may not apply to you. This warranty gives you specific legal rights, and you may also have other rights that vary from province to province, state to state or jurisdiction to jurisdiction. How to Obtain Warranty Service In the U.S.A. If you have any question regarding this warranty or would like to obtain warranty service, please call 18002532764 and a convenient service center address will be provided to you. <http://azlawncare.com/userfiles/dell-precision-410-manual.xml>



In Canada If you have any question regarding this warranty or would like to obtain warranty service, please call 18002532764 and a convenient service center address will be provided to you.

In the U.S.A., this warranty is offered by Sunbeam Products, Inc doing business as Jarden Consumer Solutions located in Boca Raton, Florida 33431. In Canada, this warranty is offered by Sunbeam Corporation Canada Limited doing business as Jarden Consumer Solutions, located at 20 B Hereford Street, Brampton, Ontario L6Y 0M1. If you have any other problem or claim in connection with this product, please write our Consumer Service Department. All Rights Reserved. Distributed by Sunbeam Products, Inc. BWM260108EM2 Printed in China Read instructions before operating. Retain for future reference. Filter Free Warm Moisture Humidifier MODEL BWM2601 STORAGE INSTRUCTIONS If your humidifier will not be in use for two days or more, or at the end of the season follow these instructions. 1. Clean and dry the humidifier thoroughly as per the "Weekly Maintenance" instructions. 2. Let the humidifier dry completely before storing. Do not store with water inside the base or water reservoir. 3. Remove the reservoir cap. Do not store with the tank cap in place. 4. Store in a cool dry location. Unit not plugged in. Unit not reset after refilling tank. Scale buildup in tray. Scale buildup on heating element. Remove tray and flush out scale residue. Remove scale from heating element. Shut off and unplug before removing the water reservoir and moving the unit. 16. This humidifier requires daily and weekly maintenance to operate appropriately. Refer to daily and weekly cleaning procedures. Use only cleaners and additives recommended by the manufacturer. 17. NEVER use detergents, gasoline, glass cleaner, furniture polish, paint thinner, or other household solvents to clean any part of the humidifier. 18. Excessive humidity in a room can cause water condensation on windows and some furniture.

If this happens, turn the humidifier OFF. 19. Do not use humidifier in an area where humidity level is in excess of 50%. Use a hygrometer, available at your local hardware store or through Bionaire, to measure the humidity. 20. DO NOT attempt to repair or adjust any electrical or mechanical functions on this unit. Doing so will void your warranty. The inside of the unit contains no user serviceable parts. All servicing should be performed by qualified personnel only. 21. Never place humidifier housing under water flow or immerse in liquids. 22. Do not plug in the cord with wet hands electric shock could result. 23. Do not pour water in any openings other than the water tank. 24. To prevent damage to surfaces, do not place humidifier under overhanging surfaces. 25. NEVER operate unit without water in the tank. 26. Use both hands when carrying full tank of water. PLEASE SAVE THESE INSTRUCTIONS CONSUMER SAFETY INFORMATION This appliance has a POLARIZED AC PLUG one blade is wider than the other. To reduce the risk of electric shock, this plug is intended to fit in a polarized outlet only one way. If the plug does not fit fully in the outlet, reverse the plug. If it still does not fit, contact a qualified electrician to install the proper outlet. If a longer cord is necessary an OPERATING INSTRUCTIONS 1. Plug the power cord into a 120V AC electrical outlet. 2. Turn the Mode Knob to the High position II. The Power Light will be On and the Refill Light will be Off. RESET PROCEDURE NOTE When the water tank is empty and the water in the heating chamber is almost empty, the Automatic Shut Off will activate. The Refill Light will illuminate and the unit will not operate again until you refill the water tank and reset the humidifier. 1. Turn the Mode Knob to off O. 2. Unplug the unit. 3. Remove and refill the water tank, being sure to follow the Daily Maintenance Instructions. Replace the tank onto the base.

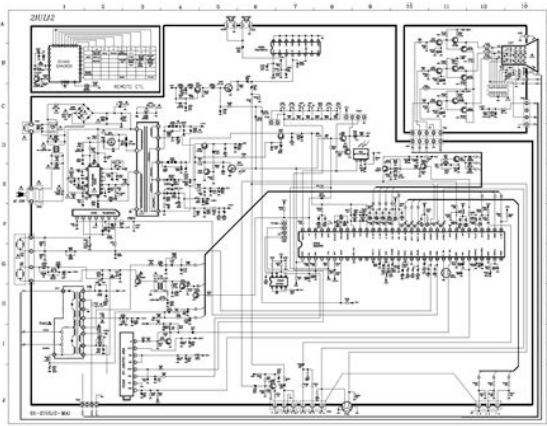

<http://www.bosport.be/newsletter/3m-724-esd-monitor-manual>

The electrical rating of the extension cord must be equal to or greater than the rating of the humidifier refer to rating artwork placed on the humidifier. Care must be taken to arrange the extension cord so that it will not drape over the countertop or tabletop where it can be pulled on by children or accidentally tripped over. Air is drawn in through the grill openings and mixed with steam in the misting chamber. The warm mist is then dispersed out of the top of the misting chamber through the outlet grill and into the room. Warm moisture humidifiers put moisture back into the air you breathe to help relieve sinus and respiratory discomforts, reduce annoying static electricity and provide a healthy growing environment for your indoor plants.

**PREOPERATING INSTRUCTIONS**

1. Be sure the humidifier is switched off and disconnected from the electrical outlet.
2. Select a location for your humidifier, on a flat surface, about 4 inches 10 cm away from the wall. Do not place your humidifier on furniture, a floor location that will not be damaged by moisture is best.
3. Remove the water tank by holding the tank handle and lifting straight upwards.

**FILLING THE WATER TANK**

1. Twist off the water tank cap located on the bottom of the water tank by turning counter clockwise and fill the water tank with cool fresh water. Do not fill with warm water as this may cause leaking.
2. After filling the water tank, replace the water tank cap by firmly turning clockwise and then replace the water tank onto the base. The water tank will immediately begin to empty into the base.

**DAILY MAINTENANCE** Allow to cool before maintenance.

1. Before cleaning, set the control to off position O and unplug the unit from the electrical outlet.
2. Remove the water tank then unlock the misting chamber by rotating the safety lock towards the front of the unit. Lift mist chamber from the unit's base. Now lift the tray from the base.
- 3.

<http://garantbouw.com/images/brass-eagle-manuals.pdf>

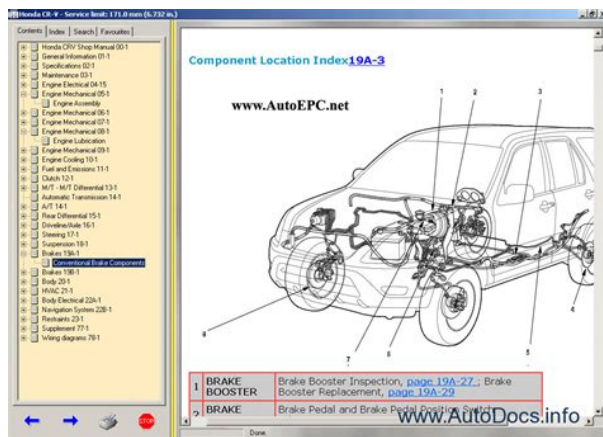

Empty water and minerals from the tray and place in the top rack of the dishwasher. This will

remove any sediment and dirt that has accumulated in the tray. NOTE It is imperative that the tray is cleaned properly. The tray is dishwasher safe top rack ONLY for easy cleaning. 4. Wipe the heating element clean with a soft cloth after it has had a chance to cool. 5. Replace misting chamber and engage safety lock. The Electronic Thermal Control Heating element is provided with a special coating that is designed to provide the easiest cleaning and prolong the operating efficiency of the humidifier. DO NOT use any metal or hard objects to clean the Heating Element. Never use detergents, gasoline, kerosene, glass cleaner, furniture polish, paint thinner or other household solvents to clean any part of the humidifier. WEEKLY MAINTENANCE Remove scale Allow to cool before maintenance. 1. Repeat steps 15 in the Daily Maintenance section. 2. Clean the tray by partially filling the tray with one 8oz cup of undiluted white vinegar. Let solution stand 20 minutes, cleaning all interior surfaces with a soft brush. Dampen a cloth with undiluted white vinegar and wipe out entire tray to remove scale. 3. Rinse with clean warm water to remove scale and the white vinegar solution before beginning to disinfect the tank. 4. Wipe the heating element clean with a soft cloth after it has had a chance to cool. Water Tank Control Panel Fig 1 Humidifier Housing Tank Handle Water Tank Safety Lock Tab 4. Wait 20 minutes for Automatic ShutOff to reset. 5. After 20 minutes, plug in the unit and turn the Mode Knob to High. The Refill Light should now be off if not repeat steps 1 through 5. In about 10 minutes, the humidifier will begin to produce moisture. If the Refill Light is still on at this point, and the unit does not begin to produce moisture within a few minutes, then repeat Steps 15.

<http://ambarevleri.com/images/brass-eagle-raider-paintball-gun-manual.pdf>



IMPORTANT If you do not plan to use the humidifier for two or more days, make sure any residual water is drained from the water tank and base to prevent algae or bacteria growth. WARM MIST CLEANING AND MAINTENANCE INSTRUCTIONS The following maintenance procedures must be routinely followed in order to ensure proper, efficient operation of your humidifier. The unit may not operate properly without following the cleaning and maintenance instructions. When the unit is in use, daily and weekly maintenance is recommended. Regular weekly cleaning prevents scale buildup on the heating element and tray. It also prevents microorganisms from growing on the tray and tank. This ensures that maximum efficiency will be achieved. The manufacturer cannot overemphasize how essential proper cleaning is to the maintenance and continued use of your unit and to the avoidance of algae or bacteria buildup. Mode Knob Refill Light Fig 2 Power Light HUMIDIFIER SAFETY PLEASE READ AND SAVE THESE IMPORTANT SAFEGUARDS When using electrical appliances, basic safety precautions should always be followed to reduce the risk of fire, electric shock, and injury to persons, including the following 1. Read all instructions before using the appliance. 2. To avoid fire or shock hazard, plug the appliance directly into a 120V AC electrical outlet. 3. Keep the cord out of heavy traffic areas. To avoid fire hazard, NEVER put the cord under

rugs, near heat registers, radiator, stoves, or heaters. 4. DO NOT place humidifier near heat sources such as stoves, radiators, and heaters. Do locate your humidifier on an inside wall near an electrical outlet. The humidifier should be at least 4 inches 10 cm away from the wall for best results. 5. NEVER place humidifier in an area where it is accessible to children. NEVER use humidifier in a closed room, particularly where a child may be sleeping, resting, or playing a closed room may result in excessive humidity. 6.

WARNING Do not attempt to refill humidifier without first unplugging the unit from its electrical outlet. Failure to heed this warning may cause personal injury. 7. NEVER place anything over moisture outlet when unit is running. 8. NEVER drop or insert any object into any openings. 9. DO NOT operate any appliance with a damaged cord or plug, if the appliance malfunctions, or if it has been dropped or damaged in any manner. Return appliance to manufacturer for examination, electrical or mechanical adjustment, or repair. 10. Use appliance only for intended household use as described in this manual. Any other use not recommended by the manufacturer may cause fire, electric shock, or injury to persons. The use of attachments not recommended or sold by the manufacturer may cause hazards. 11. DO NOT use outdoors. 12. Always place humidifier on a firm, flat, level surface. 4 inches 10 cm from wall. A waterproof mat or pad is recommended for under the humidifier. NEVER place it on a rug or carpet, or on a finished floor that may be damaged by exposure to water or moisture. 13. DO NOT allow the moisture outlet to directly face the wall. Moisture could cause damage, particularly to wall paper. 14. Humidifier should be unplugged when not in use. Patented Venturi design of misting chamber requires no fan and motor. Optional Demineralization cartridge helps extend the lifetime of heating element. Filters Lifetime 23 Months depending on usage and quality of water. Filter 1 Optional water filter WMF50. Filling Capacity 2.0 Gallons. Daily humidity output 2.5 Gallons. Runs on one refill for up to 24 hours. Level of Noise Low Very Quiet below 30 dB High Quiet below 35 dB Maximum humidifying area tight constructions 700 sq. ft. Maximum humidifying area average constructions 350 sq. ft. Power consumption Low 200, High 350 Watts. Microban protection inhibits growth of odor causing bacteria and mold. Removable tank with carry handle makes filling easy.

<https://ednak.com/wp-content/plugins/formcraft/file-upload/server/content/files/1626eabb16c5ea---bosch-maxx-6-owners-manual.pdf>

Dishwasher safe tray eases required cleaning. Large, easy to remove tank cap for ease of filling and cleaning. Triple thermostatic protection from overheating. Automatic power shutoff when tank empty. Integrated control panel in the top for comfort operation. Separate Power On and Refill indicator lights. Lightweight portable design easy to carry from room to room. BIONAIRE is a registered trademark of BIONAIRE Inc. Please turn it on so that you can experience the full capabilities of this site. These marks are used under license by Sunbeam Products, Inc. Antimicrobial additive is not designed to protect users from disease causing microorganisms. Antimicrobial additive inhibits the growth of microorganisms that cause stains and odors. Antimicrobial action limited to product surface. Visit our Preferred Retail Partners Please turn it on so that you can experience the full capabilities of this site. Antimicrobial action limited to product surface. 5 if cleaned properly You may unsubscribe at any time. 20B Hereford Street, Brampton, ON L6Y 0M1, 18002532764. Please check your inbox, and if you can't find it, check your spam folder to make sure it didn't end up there. Please also check your spam folder. Retain for future reference. To avoid burns, DO NOT let bare skin touch hot surfaces. If provided, use handles when moving this heater. Keep combustible materials, such as furniture, pillows, bedding, papers, clothes, and curtains at least 3 ft 0.9 m from the front of the heater and keep them away from the sides and rear. DO NOT cover cord with throw rugs, runners, or the like. Arrange cord away from traffic area and where it will not be tripped over. NEVER locate heater where it may fall into a bathtub or other water container. Return appliance to manufacturer for examination, electrical or mechanical

adjustment, or repair. DO NOT use it in areas where gasoline, paint, or flammable liquids are used or stored.

Any other use not DO NOT use on soft surfaces, like a bed, where openings may become blocked. However, if you have to use an extension cord, the cord shall be No. 14 AWG minimum size and rated not less than 1875 watts. This plug will fit into the power outlet only if it still does not fit, contact qualified personnel to install the proper outlet. If a longer cord is necessary an approved extension cord may be used. The electrical rating of the extension cord must be equal to or greater than the rating of the heater. Care must be taken to arrange the extension cord where it cannot be pulled. Retain for future reference. Instruction Leaflet INFOLINE If after having read this leaflet, you have any questions or comments on your humidifier, call 18002532764 in North America. Model BCM4510 Shown. Login to post Can you tell me of any common issues and their remedies for this humidifier Humidifier power light is staying red and Humidifier is working than stops Ensure that water level sensor is Ensure it is properly plugged into a Its new and did it when I first started it but i cant find the receipt to return it. Any way to fix it Worked with my crane duck humidifier. Hope it helps Humidifier is working than stops Ive got the BWM2600 filterless and this deposit has hardened on the inside and seems to be slowing down or preventing the vapor from coming. Answer questions, earn points and help others. JCS, at its option, will repair or replace this product or any component of the product found to be defective during the warranty period. Replacement will be made with a new or remanufactured product or component. If the product is no longer available, replacement may be made with a similar product of equal or greater value. This is your exclusive warranty. Do NOT attempt to repair or adjust any electrical or mechanical functions on this product. Doing so will void this warranty.

This warranty is valid for the original retail purchaser from the date of initial retail purchase and is not transferable. Keep the original sales receipt. Proof of purchase is required to obtain warranty performance. JCS dealers, service centers, or retail stores selling JCS products do not have the right to alter, modify or in any way change the terms and conditions of this warranty. This warranty does not cover normal wear of parts or damage resulting from any of the following negligent use or misuse of the product, use on improper voltage or current, use contrary to the operating instructions, disassembly, repair or alteration by anyone other than JCS or an authorized JCS service center. Further, the warranty does not cover Acts of God, such as fire, flood, hurricanes and tornadoes. What are the limits on JCS's Liability. JCS shall not be liable for any incidental or consequential damages caused by the breach of any express, implied or statutory warranty or condition. Except to the extent prohibited by applicable law, any implied warranty or condition of merchantability or fitness for a particular purpose is limited in duration to the JCS discloses all other warranties, conditions or representations, express, implied, statutory or otherwise. JCS shall not be liable for any damages of any kind resulting from the purchase, use or misuse of, or inability to use the product including incidental, special, consequential or similar damages or loss of profits, or for any breach of contract, fundamental or otherwise, or for any claim brought against purchaser by any other party. Some provinces, states or jurisdictions do not allow the exclusion or limitation of incidental or consequential damages or limitations on how long an implied warranty lasts, so the above limitations or exclusion may not apply to you.

This warranty gives you specific legal rights, and you may also have other rights that vary from province to province, state to state or jurisdiction to jurisdiction. How to Obtain Warranty Service In the U.S.A. If you have any question regarding this warranty or would like to obtain warranty service, please call 18002532764 and a convenient service center address will be provided to you. In Canada If you have any question regarding this warranty or would like to obtain warranty service, please call 18002532764 and a convenient service center address will be provided to you. In the U.S.A., this warranty is offered by Sunbeam Products, Inc doing business as Jar den

Consumer Solutions located in Boca Raton, Florida 33431. In Canada, this warranty is offered by Sunbeam Corporation Canada Limited doing business as Jarden Consumer Solutions, located at 20 Bedford Street, Brampton, Ontario L6Y 0M1. If you have any other problem or claim in connection with this product, please write our Consumer Service Department. All Rights Reserved. Distributed by Sunbeam Products, Inc. BWM260108EM2 Printed in China Read instructions before operating. Retain for future reference. Filter Free Warm Moisture Humidifier MODEL BWM2601 STORAGE INSTRUCTIONS If your humidifier will not be in use for two days or more, or at the end of the season follow these instructions. 1. Clean and dry the humidifier thoroughly as per the "Weekly Maintenance" instructions. 2. Let the humidifier dry completely before storing. Do not store with water inside the base or water reservoir. 3. Remove the reservoir cap. Do not store with the tank cap in place. 4. Store in a cool dry location. Unit not plugged in. Unit not reset after refilling tank. Scale buildup in tray. Scale buildup on heating element. Remove tray and flush out scale residue. Remove scale from heating element. Check other Bionaire manuals.

<http://www.diamondsinthemaking.com/content/3m-724-esd-monitor-manual>