

Cuisinart grind and brew thermal manual



File Name: Cuisinart grind and brew thermal manual.pdf

Size: 4306 KB

Type: PDF, ePub, eBook

Category: Book

Uploaded: 13 May 2019, 20:13 PM

Rating: 4.6/5 from 656 votes.

Download Now!

Please check the box below to proceed.



I'm not a robot



reCAPTCHA
Privacy - Terms

Book Descriptions:

Cuisinart grind and brew thermal manual



It must never be used on the range top. SAFEGUARDS 16. Do not set a hot carafe on a wet or cold When using electrical appliances, basic surface. Do not use a damaged carafe or a carafe followed to reduce the risk of fire, electric having a loose or weakened handle. Do not clean carafe or heating plate wTo reduce The lightning flash with arrowhead the risk of electric shock, this plug will fit symbol within an equilateral into a polarized outlet only one way. If the triangle is intended to alert the plug does not fit fully into the outlet, reverse user to the presence of uninsulated the plug. If it still does not fit, contact a dangerous voltage within the qualified eleThe quality of that Control Panel. 6 water is as important as the quality of Programming Your Coffeemaker. 7 your coffee. If water doesn't taste good from the tap, it won't taste good in your Setting the ProgSee detailed drawing 14. Water Reservoir with Water Level on page 6. Indicator 2. Showerhead not shown Distributes water evenly over coffee, Note Lid must be in place for unit to operate. 16 16. Grinder Basket 17. Filter Basket Cover To put on or remove, grasp cover in area 13 14 indicated by arrows. Use caution when removing cover. 18. Gold Tone Cuisinart Commercial 17 Style Filter A note about filters When usinWhen the coffeemaker is plugged in, 1200 Simply follow "Making Coffee with Pre will appear until you set the time. Press Once you've donNOTE produce cooler coffee when brewing Some ground coffee may flow into small pots because the heater the carafe. You'll have to decide that one for yourself. Your coffeemaker comes with a charcoal water filter that eliminates chlorine, bad tastes and odors from MAKING COFFEE WITH tap water. PREGROUND BEANS Inserting the Water Filter Follow instructions in "Before Brewing Your First Pot of Coffee," page 7. soak it, fully immersed, in cold tap 1. Fill the Reservoir and Insert Filter water for 15 minutes. <http://www.ponikwa.pl/htdocs/userfiles/how-to-manually-remove-exchange-2003-from-sbs-2003.xml>

- **cuisinart grind and brew thermal manual, cuisinart grind and brew thermal 10 cup coffee maker manual, cuisinart grind and brew thermal instructions, cuisinart grind and brew thermal parts, cuisinart automatic grind and brew thermal manual, cuisinart automatic grind and brew thermal instructions, cuisinart automatic grind and brew thermal troubleshooting, cuisinart grind and brew thermal manual,**

cuisinart grind and brew thermal user manuals.



COMPLETELY CLEAN AND DRY For best performance from your coffeemaker, ALL PARTS AFTER EVERY USE decalcify the base unit from time to time. Always turn coffeemaker OFF and remove The frequency depends upon the hardness the plug from the electrical outlet before of your tap water and how often you use the cleaning. Allow to cool before putting on or taking of f parts and before cleaning the appliance. 6. Do not operate any appliance with a damaged cord or plug or after the appliance malfunctions or has been dropped or damaged in any manner. Return appliance to the nearest Cuisinart Repair Center for examination, repair, and electrical or mechanical adjustment. 7. The use of accessory attachments not recommended by Cuisinart may cause injuries. 8. Do not use outdoors. 9. Do not let cord hang over edge of table or counter, or touch hot surface. 10. Do not place on or near a hot gas or electric burner, or in a heated oven. 11. Always fill water reservoir first, then plug cord into the wall outlet. T o disconnect, push the Off button, then r emove plug from wall outlet. 12. Do not use appliance for other than intended use. 13. Lock lid securely onto carafe before serving any beverages. 14. Scalding may occur if the lid is removed during the brewing cycle. 15. The thermal carafe is designed for use with this appliance only. It must never be used on the range top. 16. Do not set a hot carafe on a wet or cold surface. 17. Do not use a damaged carafe or a carafe having a loose or weakened handle. 18. Do not clean carafe or heating plate with cleansers, steel wool pads, or other abrasive materials. 19. WARNING TO REDUCE THE RISK OF FIRE OR ELECTRIC SHOCK, DO NOT REMOVE THE BASE P ANEL. The exclamation point within an equilateral triangle is intended to alert the user to the presence of important operating and maintenance servicing instructions in the literature accompanying the appliance. <http://thoseduelingpianos.com/userfiles/how-to-manually-remove-exchange-2003-log-files.xml>



SPECIAL CORD SET INSTRUCTIONS A short power supply cord is provided to reduce the risks resulting from becoming entangled in or tripping over a longer cord. Longer extension cords are available and may be used if care is exercised in their use. If a long extension cord is used, the marked electrical rating of the extension cord must be at least as great as the electrical rating of the appliance, and the longer cord should be arranged so that it will not drape over the countertop or tabletop where it can be pulled on by children or tripped over. **NOTICE** This appliance has a polarized plug one blade is wider than the other. To reduce the risk of electric shock, this plug will fit into a polarized outlet only one way. If the plug does not fit fully into the outlet, reverse the plug. If it still does not fit, contact a qualified electrician. Do not modify the plug in any way. The quality of that water is as important as the quality of your coffee. If water doesn't taste good from the tap, it won't taste good in your coffee. Cuisinart includes a charcoal water filter to remove chlorine, bad tastes and odors, for the purest coffee flavor, every time you brew. **Element 2 Coffee** While coffee is 98% water, all of the flavor comes from the beans. To achieve the same great taste you enjoy at a coffee bar, buy only a two-week supply of fresh coffee beans at a time. Once the bean is broken, its flavor degrades quickly. That's why Cuisinart grinds your beans just prior to brewing. **Element 3 Grind** The grind is critical for proper flavor extraction. If the grind is too fine, overextraction and bitterness will result. Too fine a grind may also clog the filter. If grind is too coarse, the water will pass through too quickly and the maximum flavor will not be extracted. Your coffeemaker is preset for medium, the optimal grind for this type of brewing process. **Element 4 Proportion** Coffee that is too strong or too weak is always a disappointment.

Follow the recommended portions of whole beans or ground coffee in the instructions under **MAKING COFFEE**, and later adjust the amount to your taste. See detailed drawing on page 6. 2. Showerhead not shown Distributes water evenly over coffee, reducing temperature loss as water passes through grounds. 3. Control Panel See detailed drawing on page 6. 4. Filter Basket Compartment See detailed drawing on page 6. Contains Filter Basket Filter Basket Cover Cuisinart Gold Tone Commercial Style Filter 5. Filter Basket Door 6. Filter Basket Door Release Button not shown 7. Brew Pause Stops flow of coffee from basket when carafe is removed from resting plate, so a cup can be poured in midbrew, if desired. 8. Resting Plate Scratch resistant with nonstick coating. 9. Thermal Carafe with HandsFree Lid An easypour, dripless doublewall insulated 10cup thermal carafe with ergonomic handle. Coffee brews through and pours through a unique lid that seals out air to preserve freshly brewed flavor. No need to turn or adjust lid. 10. Cord Storage not shown 11. Charcoal Water Filter not shown Charcoal water filter eliminates chlorine, bad tastes and

odors from tap water. NOTE Follow directions for preparing and inserting filter on page 9. 14. Water Reservoir with Water Level Indicator 3 7 1 4 8 9 14 5 Note Lid must be in place for unit to operate. 16. Grinder Basket 17. Filter Basket Cover To put on or remove, grasp cover in area indicated by arrows. Use caution when removing cover. 18. Gold Tone Cuisinart Commercial Style Filter A note about filters When using our permanent filter, position handle toward front of the unit so it does not interfere with the flow of coffee into the filter basket. Also note using our permanent goldtone filter may allow some fine coffee grounds to fall into, and appear as sediment in the carafe. 19. Filter Basket Holds our commercial style permanent filter or paper filter. Removable for easy cleaning.

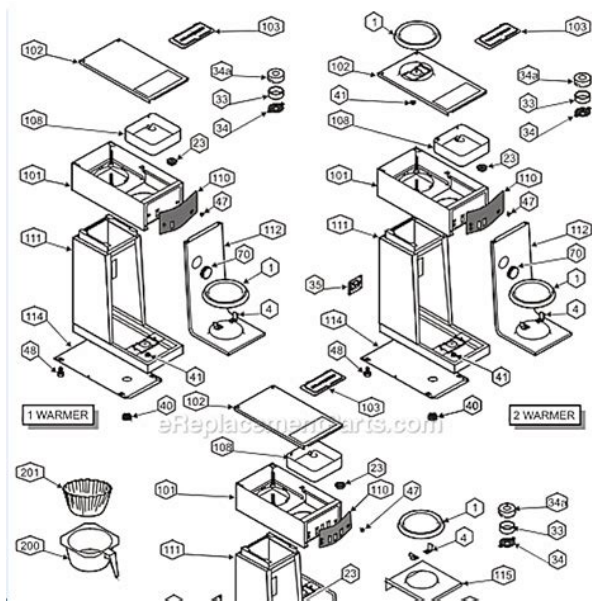

Audible Tone not shown An audible tone sounds 5 times when brew cycle is complete. 14 Cup Setting Improves extraction, flavor and temperature when brewing fewer than 5 cups. Hour and Minute Buttons Use to program clock and Auto On function. Grind Off Button with LED Indicator Turns off the grinder when using preground coffee. Entering Time Set Mode Hold down the Hour or Minute button until the clock begins flashing. Press either button to select the desired time. Hold buttons down to scroll through the digits, or press and release to advance one digit at a time. When scrolling, the numbers will advance slowly and then speed up. When the number displayed approaches the desired time, press and release to advance one digit at a time. Be sure the PM indicator is on if a PM time is desired. Exiting Time Set Mode a. Press any function button besides Hour or Minute to exit mode. b. If you do nothing for a period of five seconds the mode will be exited. SETTING THE PROGRAM TIME When you press the Program set button, it displays a previously selected autoon time, or the default time 1200pm. Entering Set Program Time Mode Press and hold the Program set button until the green light and LCD display begin to flash. You are now in Set Program Time mode. Set the time you want coffee to begin brewing by following the instructions in "Entering Time Set Mode." The coffeemaker will start to brew at the programmed time. The Program mode cannot be entered if the coffeemaker is in its brew cycle. Exiting Set Program Time Mode a. Press and release Program button. b. Press any function button besides Hour or Minute to exit mode and activate the selected function. c. If you do nothing for a period of five seconds the mode will be exited. MAKING COFFEE WITH WHOLE BEANS Follow instructions in "Before Brewing Your First Pot of Coffee" above. 1. Insert Charcoal Water Filter Follow directions for the preparation and insertion of the charcoal water filter on page 9. 2.

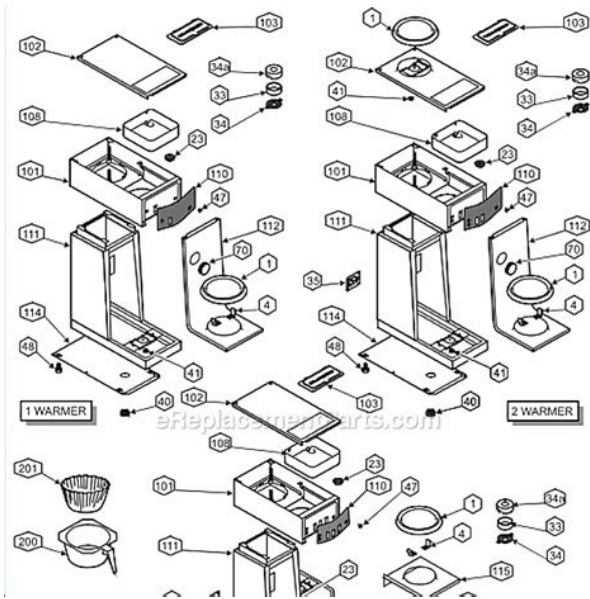

Fill the Water Reservoir Open the reservoir cover and pour in water, using the water level window indicator to measure the number of cups desired. NOTE Do not exceed the 10cup line. Doing so could cause carafe to overflow. 3. Add Beans Lift the grinder basket lid, using the recess on either side. Fill the basket with the desired quantity of beans. NOTE Use 1 level scoop of whole beans per cup. For 1 to 4 cups, use 1 level scoops per cup. Do not add over 14 scoops. BEFORE BREWING YOUR FIRST POT OF COFFEE We recommend flushing out the system before brewing your first pot of coffee. Once you've done that, brew a pot of real coffee and get ready to enjoy Cuisinart at its best! Close Reservoir Cover Lid Press down to lock. This coffee maker is equipped with a safety interlock system, which prevents the unit from operating if the cover is open or the grinder cover is left out. If you try to turn the unit on with the cover open, the unit will beep continuously until the missing parts are installed and you close the lid. If you open the cover during the grinding process, it will beep, the grinder will stop grinding and, if brewing, the brewing will stop. Once the missing parts are in place and the cover is closed, the beeping stops. The brewing process can be restarted by pressing the On button. Restarting the process will not affect coffee results. If you do not want the grinder to come on again, press the Grind Off button before pressing the On button. 7. Prepare the Carafe Remove thermal carafe lid by turning in the direction of the "unlock" arrow. This ensures cover is closed and in the proper position for brewing and pouring. Make sure you have replaced the thermal carafe in its position on the resting plate. 8. Brewing To Brew Right Away a. Push the 14 cup button if you are brewing fewer than 5 cups. NOTE Coffeemakers traditionally produce cooler coffee when brewing small pots because the heater doesn't have time to warm up.



Red LED will light up and brewing will begin. To Program Brew Time a. To select the time you want coffee to start brewing, press the Program button and hold it. The time displayed in the window is the programmed start time. To change time, follow "Setting The Program Time" instructions on page 7. b. Push the 14 cup button if you are brewing fewer than 5 cups. c. Press and release Program button. Green LED indicates that the unit is in programmed start mode and the brew cycle will begin at the time you selected. 9. After Brewing When brew cycle is complete, five beeps will sound and unit will automatically shut itself off. Coffee will continue to stream from the filter for several seconds. The thermal carafe will keep coffee hot for hours. Bottom of thermal carafe is hot to touch for several minutes after brewing. Preserve freshness by minimizing exposure to air, light, and moisture. Once beans are removed from the freezer, keep them in a sealed container at room temperature, since damaging condensation can occur when beans move from cold to warmer temperatures. Adjust the recipe according to taste. NOTE The maximum capacity for ground coffee is 16 level scoops, using either a paper or permanent filter. Inserting the Water Filter 3FNPWF UIF GJMUFGSPNQPMZCBH BOE soak it, fully immersed, in cold tap water for 15 minutes. NOTE We recommend changing the water filter every 60 days or after 60 uses, and more often if you have hard water. Be aware that using this feature will weaken the flavor strength of the finished pot, because the flavor profile of coffee brewed at the beginning of the cycle differs from coffee made at the end. NOTE Removing carafe for more than 20 seconds may cause filter basket to overflow. Remove the grinder basket lid by using the recessed areas on each side of the lid. Then remove

grinder basket. Open filter basket door. Remove filter basket cover, filter basket and filter basket holder.

The grinder basket, grinder basket lid, filter basket and filter basket cover can be washed in warm soapy water and rinsed thoroughly, or cleaned in the upper rack of the dishwasher. Dry all parts after every use. Do not put any water in the unit once the grinder basket has been removed. Wipe the area under the grinder basket with a damp cloth. If water gets into the grinder motor, the motor may become damaged and may malfunction. Once clean, reverse the above steps. Remove the carafe from the resting plate. Discard any remaining coffee. The carafe and lid can be washed in warm soapy water and rinsed thoroughly, or placed in a dishwasher. The carafe and carafe lid should be placed on the upper rack only. Do not use scouring agents or harsh cleansers on any part of the coffeemaker. Never immerse base unit in water or other liquid. To clean base, simply wipe with a clean, damp cloth and dry before storing. Wipe resting plate with a clean, damp cloth. Never use rough, abrasive materials or cleansers to clean the resting plate. Open the lid 60 and gently pull toward you. To replace, reverse steps. **DECALCIFICATION** Decalcification refers to removing the calcium deposits which form over time on the metal parts of the coffeemaker. For best performance from your coffeemaker, decalcify the base unit from time to time. The frequency depends upon the hardness of your tap water and how often you use the coffeemaker. To clean, fill the water reservoir to capacity with a mixture of white vinegar and water. Turn the coffeemaker on by pressing the ON button. One cycle should be sufficient to adequately clean the coffeemaker. When the cycle is completed and five beeps sound, turn coffeemaker off. Repeat operation, this time using fresh cold water. Except as otherwise required under applicable law, this warranty is not available to retailers or other commercial purchasers or owners.

<https://www.kissdocs.com.au/wp-content/plugins/formcraft/file-upload/server/content/files/162888315d0f3b---canadian-firearms-manual.pdf>

We suggest you complete and return the enclosed product registration card promptly to facilitate verification of the date of original purchase. However, return of the product registration card does not eliminate the need for the consumer to maintain the original proof of purchase in order to obtain the warranty benefits. In the event that you do not have proof of purchase date, the purchase date for purposes of this warranty will be the date of manufacture. To obtain warranty service, simply call our tollfree number 1 8007260190 for additional information from our Customer Service Representatives, or send the defective product to Customer Service at Cuisinart, 150 Milford Road, East Windsor, NJ 08520. Please pay by check or money order California residents need only supply proof of purchase and should call 18007260190 for shipping instructions. Cuisinart cannot be held responsible for in transit damage or for packages that are not delivered to us. Please be sure to include your return address, daytime phone number, description of the product defect, product model number located on bottom of product, original date of purchase, and any other information pertinent to the product's return. This warranty expressly excludes any defects or damages caused by accessories, replacement parts, or repair service other than those that have been authorized by Cuisinart. This warranty does not cover any damage caused by accident, misuse, shipment or other ordinary household use. This warranty excludes all incidental or consequential damages. Some states do not allow the exclusion or limitation of these damages, so they may not apply to you. CALIFORNIA RESIDENTS ONLY California law provides that for InWarranty Service, California residents have the option of returning a nonconforming product A to the store where it was purchased or B to another retail store which sells Cuisinart products of the same type.

chloroacetic-acid.com/upload/files/20220521_120023.pdf

The retail store shall then, at its discretion, either repair the product, refer the consumer to an independent repair facility, replace the product, or refund the purchase price less the amount

directly attributable to the consumer's prior usage of the product. If the above two options do not result in the appropriate relief to the consumer, the consumer may then take the product to an independent repair facility if service or repair can be economically accomplished. Cuisinart and not the consumer will be responsible for the reasonable cost of such service, repair, replacement, or refund for nonconforming products under warranty. California residents may also, according to their preference, return nonconforming products directly to Cuisinart for repair, or if necessary, replacement, by calling our Consumer Service Center tollfree at 18007260190. Cuisinart will be responsible for the cost of the repair, replacement, and shipping and handling for such products under warranty. If servicing is needed, a representative can confirm whether the product is under warranty and direct you to the nearest service location. Important If the nonconforming product is to be serviced by someone other than Cuisinart's Authorized Service Center, please remind the servicer to call our Consumer Service Center at 18007260190 to ensure that the problem is properly diagnosed, the product serviced with the correct parts, and the product is still under warranty. Pagina 2 IMPORTANT 15. The thermal carafe is designed for useIt must never. SAFEGUARDS be used on. Pagina 3 WARNING RISK OF FIRE NOTICE. OR ELECTRIC SHOCK This appliance has a polarized plug onePagina 4 CONTENTS. Important Safeguards..... 23Charcoal Water Filter not shownPagina 6 15 15. Grinder Basket LidPagina 7 PROGRAMMING YOUR BEFORE BREWING YOURCHARCOAL WATER FILTER disagree. You'll have to decide that one. Your. Pagina 10 CLEANING AND DECALCIFICATION.

MAINTENANCE Decalcification refers to removing thePagina 12 Coffeemakers Food Toasters Blenders Cookware Ice Cream. Please try again.Please try again.Strength selector and grind control finetune intensity and volumeMeasuring scoop. Instruction bookIn order to navigate out of this carousel please use your heading shortcut key to navigate to the next or previous heading. Register a free business account Full content visible, double tap to read brief content. Please try your search again later.The 12 cup thermal carafe is double walled to seal in the heat and freshness so the last cup is as good as the first.Size 12 Cup. Style Name Thermal Carafe The unit comes equipped with a builtin burr grinder, which automatically grinds beans right before brewing, and its grindcontrol function makes it easy to program the amount of coffee to grindfrom 2 to 12 cups. In addition, its strength selector allows for choosing from strong, medium, or mild coffee. The units bean hopper holds up to a half pound of beans and comes with a sealed lid to prevent moisture. Other highlights include automatic shutoff after brewing, a grindoff option, and an integrated 2 to 4cup feature, as well as a Gold tone commercialstyle permanent filter and charcoal water filter to remove impurities, and a brewpause function for sneaking a cup midbrew. A 12cup 5 ounces each doublewall insulated thermal carafe comes included, which seals in heat and freshness so the last cup tastes as good as the first. Add to that the pleasure of choosing the flavor strength you like best, easytouse controls, and a thermal carafe that keeps coffee hot and fresh for hours and youll understand why we say this Cuisinart coffeemaker is a grind above the rest. The Quest for a Perfect Espresso It is generally agreed that there are four basic elements critical to the perfect cup Element 1. Water Coffee is 98% water. Often overlooked, the quality of the water is as important as the quality of the coffee.

A good rule of thumb is that if your water doesnt taste good from the tap, it wont taste any better in your coffee. The charcoal water filter removes chlorine, bad tastes and odors, for the purest cup of coffee every time. Element 2. Coffee While the bulk of the liquid is water, all of the flavor should be from the coffee. To achieve the same great quality of coffee you receive at a coffee bar, you need to use the same quality beans. Buy the beans fresh and whole, only about a two weeks supply at a time for maximum freshness. Once the coffee bean is broken, its flavor degrades very quickly. If it is not practical to buy small supplies, we recommend you separate larger amounts of beans into one to two week portions immediately after purchase, and freeze them in airtight containers. The best way to maximize freshness is to minimize exposure to air, light and moisture. So, once beans have been removed from the freezer, maintain them in a sealed container at room temperature, since damaging

condensation occurs every time the beans are removed from the freezer or refrigerator. Note that some coffee experts advise against freezing darkroast beans, because freezing can cause the oils to coagulate. Other experts disagree. We suggest you experiment and decide yourself. We recommend keeping the hopper at least half way full. Be sure that you have sufficient amount of beans in your hopper for the amount of coffee you intend to brew. Although it is preferable to use fresh, whole beans, you can make coffee in the coffeemaker using preground beans. To do so, turn off the grinder by pressing the Grind Off button before turning on the unit. It is suggested to use 1 level scoop of ground coffee per cup and adjust the amount to your taste. The maximum capacity for ground coffee is 16 level scoops, using either a paper or permanent filter. Exceeding this amount may cause overflow. Element 3. Grind The grind of the coffee is critical for proper flavor extraction.

If the grind is too fine, over extraction and bitterness will result. Too fine a grind may also clog the filter. If the grind is too coarse, the water will pass through too quickly and the desired flavors will not be extracted. Making Coffee with Whole Beans 12cup thermal caraffe Fill the Water Reservoir Open the reservoir lid. Pour the desired amount of water in the reservoir using the water level window indicator. Close the reservoir lid. Note Do not exceed the 12cup line; doing so may cause the carafe to overflow. Add Beans Lift the hopper lid, using the recess on either side. Fill the hopper with beans. It is recommended keeping the hopper at least halfway full. Overpacking may result in jamming the grinder. For easy filling, the hopper container can be taken out by turning the hopper container release knob to the unlock position. Note Do not put any water in the unit once the hopper container has been removed. If the water gets into the grinder motor, the motor may become damaged and may malfunction. Put hopper lid back in place. Lock Hopper If you have removed the hopper from the unit, be sure that the hopper container release knob is in the unlocked position and place the hopper container back in the unit. Turn the knob to locked position. This unit is equipped with a safety interlock system. The unit will not grind if the hopper container is not in place. If you try to turn on the unit for grinding with the hopper out of place, the unit will beep continuously until the missing part is installed. The brewing process can be restarted by pressing the On button. Restarting the process will not affect coffee results. Insert Coffee Filter Open filter door by pressing filter basket door release button. The unit is equipped with a safety interlock system. The units will not operate if the filter basket cover or filter basket are not in place or if the filter door is not closed.

If you try to turn the unit on while the filter compartment is out of place, the unit will beep continuously until the missing parts are installed. Brewing Immediate Grinding and Brewing Turn the Grind Control Knob to select the number of cups you want to brew. The coffeemaker will grind the corresponding amounts of beans. The unit will automatically adjust for low cup settings. Press the Strength Control button to set the coffee strength. MILD, MED or STRONG will show on the LCD display. Press the On button. The indicator will light and process will begin. Programmed Brewing Press the Program button. The indicator will light and the display will show the programmed time for as long as the button is depressed. The display reverts back to the time of day once the button is released. Turn the Grind Control knob to select the number of cups you want to brew. The Coffeemaker will grind the corresponding amount of beans. Press the Strength Control button to set coffee strength. The coffeemaker will begin brewing at the programmed time. During and After Brewing The Brew Pause feature allows you to remove the carafe from the resting plate during midbrew. The brewing process does not stop during this period; only the flow of coffee from the basket stops. Do not remove the carafe for longer than 20 seconds or the coffee may overflow the basket. While Cuisinart offers this feature, it is not recommended that you pour coffee before the cycle has reached completion, since the coffee brewed at the beginning of the cycle has a flavor profile which is very different from the coffee made at the end of the cycle. Removing the cup during the brewing cycle will alter the flavor of the finished pot. When the brewing cycle is completed, five beeps will sound. Coffee will continue to stream from the filter for several seconds. After brewing, the unit will automatically shut itself off. The thermal carafe will keep the coffee hot for hours.

Making Coffee with PreGround Beans Simple operation control panel Fill the Water Reservoir Open the reservoir lid. Note Do not exceed the 12 cup line; doing so may cause the carafe to overflow. Add Coffee Grounds Open filter door. Place filter basket lid in place and close filter door. Brewing Immediate Grinding and Brewing Press the Grind Off button. When this function is activated, an amber LED will be illuminated. The indicator will light and the process will begin. Press the Grind Off button. For additional product information, see the reference manual above. Size 12 Cup. Style Name Thermal Carafe To calculate the overall star rating and percentage breakdown by star, we don't use a simple average. Instead, our system considers things like how recent a review is and if the reviewer bought the item on Amazon. It also analyzes reviews to verify trustworthiness. Please try again later. J. Mancini 3.0 out of 5 stars I'm comparing this product to the Cappresso machine with a built in grinder that I had for over 12 years and just loved. When it died, I knew i wanted another coffee maker with a built in grinder. I read several reviews indicating that the later model Cappressos weren't as good as they used to be. Plus this Cuisinart was rated very highly, so I thought I'd try it. First, the pluses. 1. It makes excellent tasting coffee. 2. It seems to be well made and very durable. Now, the minuses. 1. The grinder is LOUD. It's basically obnoxious. And it goes for a full 30 seconds, which can feel like an eternity. Don't plan on getting up before the rest of your household and starting a pot of coffee unnoticed. It will wake up even the heaviest of sleepers. Plus it's a blade grinder, which is not as good as the burr grinder in the Cappressos. 2. The cleaning process is a nightmare. There are 5 different pieces that MUST be cleaned each time. The steam from the brewing process gets into the grinder, which becomes caked with soggy coffee grounds.